

Specifications:

Contact Resistance: 30mΩ max at DC 100 mA

Insulator Resistance: 1000MΩ min. at DC 500V

Current Rating: 5 AMP

Dielectric Withstanding

Voltage: AC 1000V For 1 minute

Operating Temperature: -55°C÷+105°C

Contact: Brass

Housing: PBT &30% Glass Fiber(UL 94V-0)

Articolo	Position	A	B	c
05/06120-00	9	24.99	30.81	19.36
05/06122-00	15	33.32	39.20	27.64
05/06124-00	25	47.04	53.10	41.08
05/06126-00	37	63.50	69.50	57.38

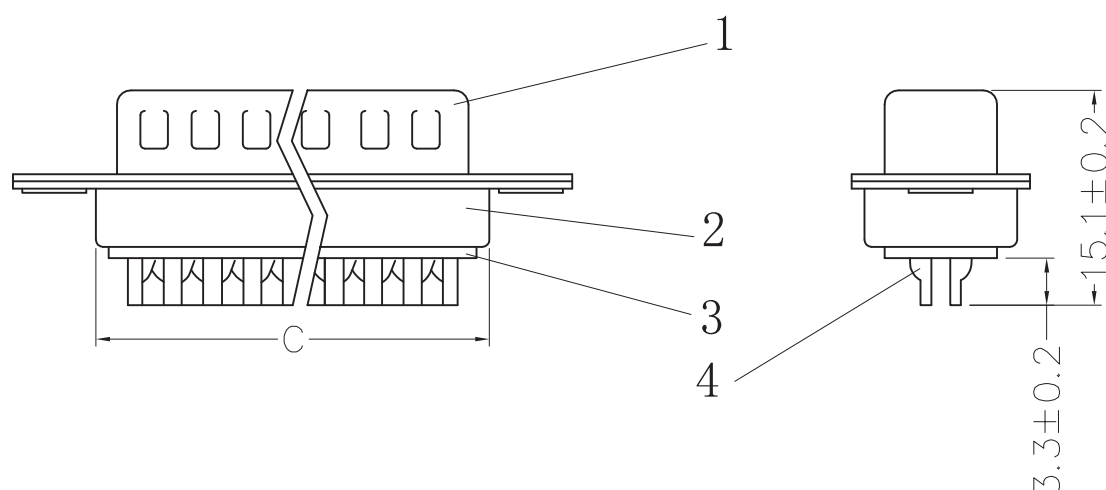
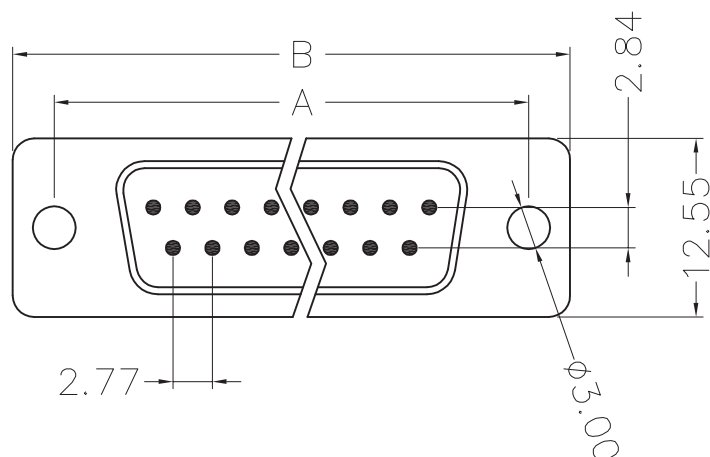

General Tolerance

x.	±0.2	x."	±2"
.x	±0.1	.x"	±1"
.xx	±0.05	.xx"	±0.5"
.xxx	±0.01		

units: mm

Specifications:

Contact Resistance: 30mΩ max at DC 100 mA

Insulator Resistance: 1000MΩ min. at DC 500V

Current Rating: 5 AMP

Dielectric Withstanding

Voltage: AC 1000V For 1 minute

Operating Temperature: -55°C÷+105°C

Contact: Brass

Housing: PBT & 30% Glass Fiber(UL 94V-0)

Articolo	Position	A	B	c
05/06100-00	9	24.99	30.81	19.36
05/06102-00	15	33.32	39.20	27.64
05/06106-00	25	47.04	53.10	41.08
05/06108-00	37	63.50	69.50	57.38

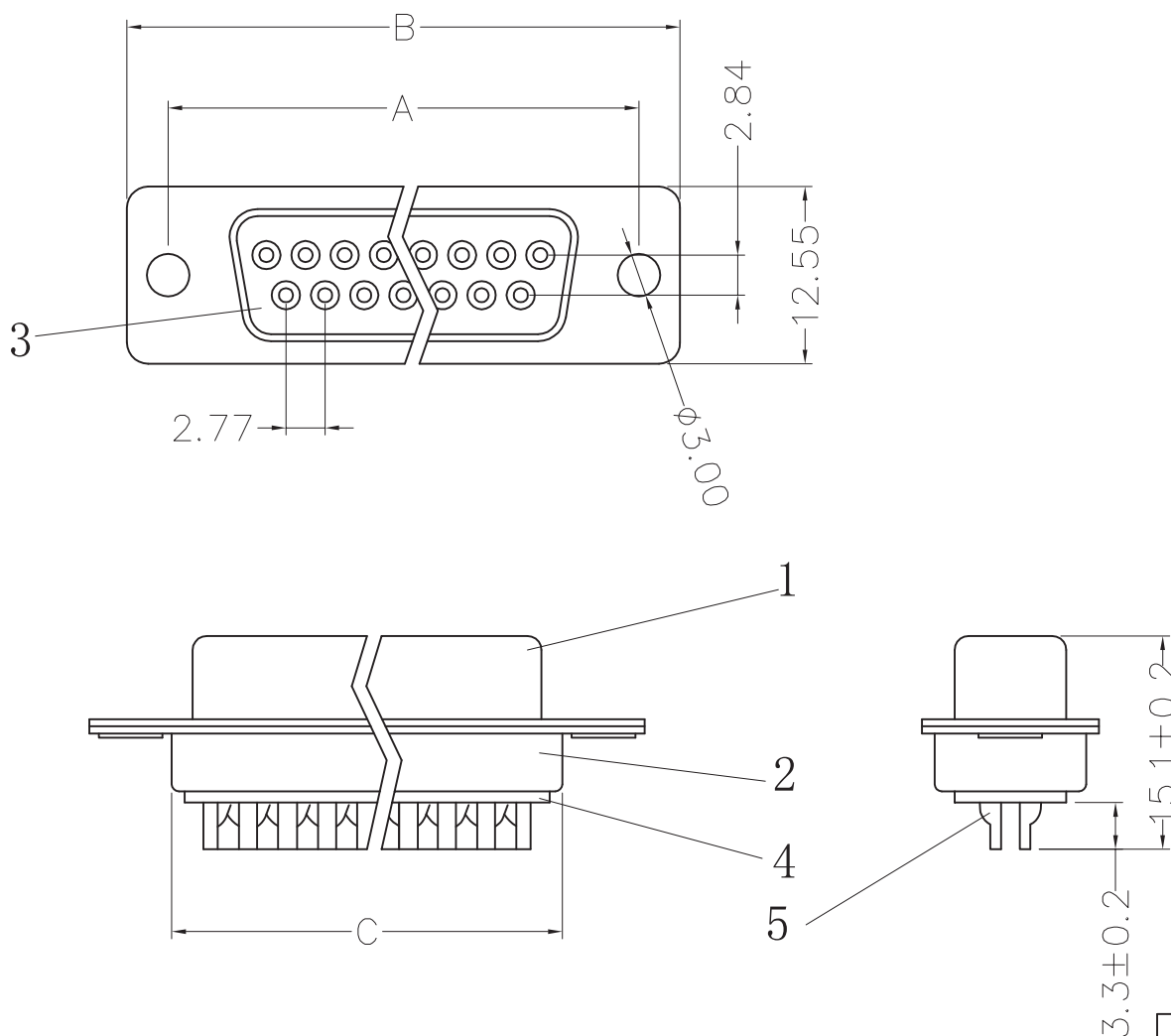

General Tolerance			
x.	±0.2	x."	±2'
.x	±0.1	.x"	±1'
.xx	±0.05	.xx"	±0.5'
.xxx	±0.01		

units: mm