

1. Contact rating: AC 125V 6A; AC 250V 3A
2. Contact R: 20mΩ Max
7. Soldering: 30W-3 sec.

3. Insulation R: 1000 MΩ Min
4. Dielectric strength: AC1500V, 1 minute

5. Operating temperature: -55 °C~85 °C
6. Electrical life: 20,000 Cycles

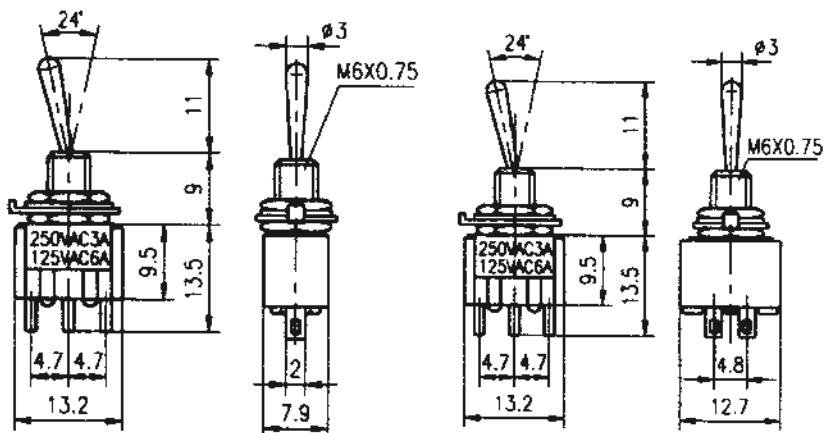

4/6567
4/6585
4/6593
4/6587

Circuitry trait			Type	Terminals
ON	—	OFF	SPST	2P
ON	—	ON	SPDT	3P
ON	—	(ON)	SPDT	3P
ON	OFF	ON	SPDT	3P
ON	OFF	(ON)	SPDT	3P
ON	OFF	(ON)	SPDT	3P

Circuitry trait			Type	Terminals
ON	—	OFF	DPST	4P
ON	—	ON	DPDT	6P
ON	—	(ON)	DPDT	6P
ON	OFF	ON	DPDT	6P
ON	OFF	(ON)	DPDT	6P
(ON)	OFF	(ON)	DPDT	6P

Handle options

Standard (A)

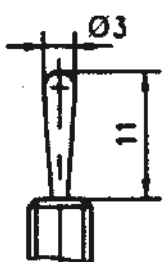

Short(C)

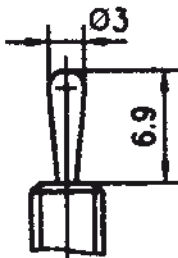

Toggle cap(D)

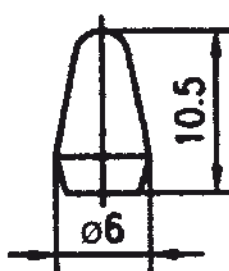

Plastic Flat(E)

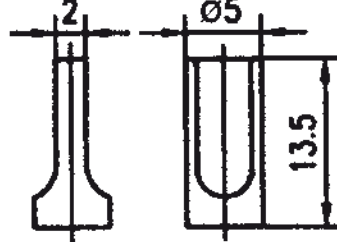

Metal Flat(F)

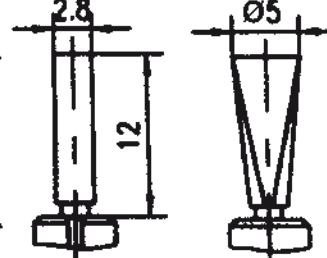

Terminal options

Solder terminal(1)

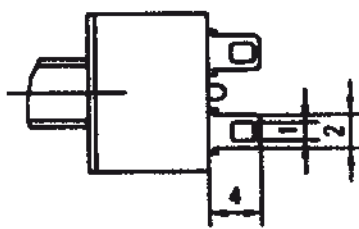

PC terminal(2)

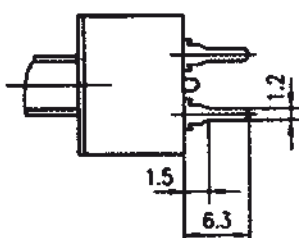

PC-H terminal(3)

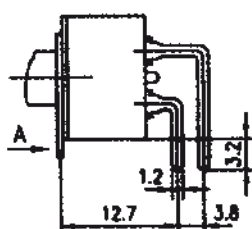

A



PC-V terminal(4)

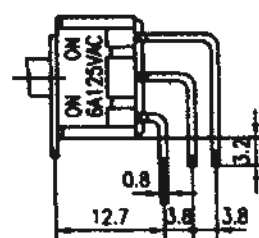

A



4/6587 ON - OFF - (ON)

4/6593 ON - OFF - ON

4/6567 ON-ON

4/6585 ON - (ON)

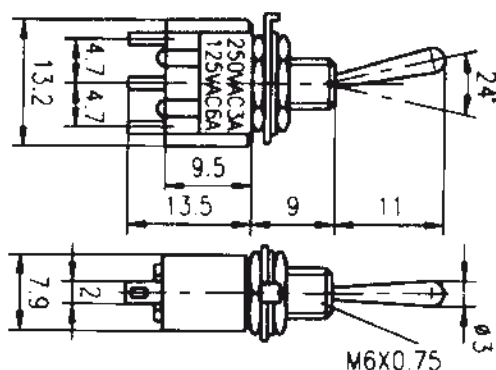

Affix Annex

Nameplate

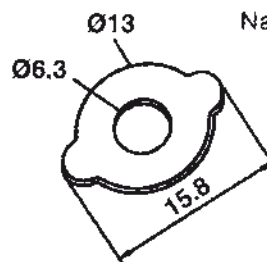

ON	—	OFF
ON	—	ON
ON	OFF	ON