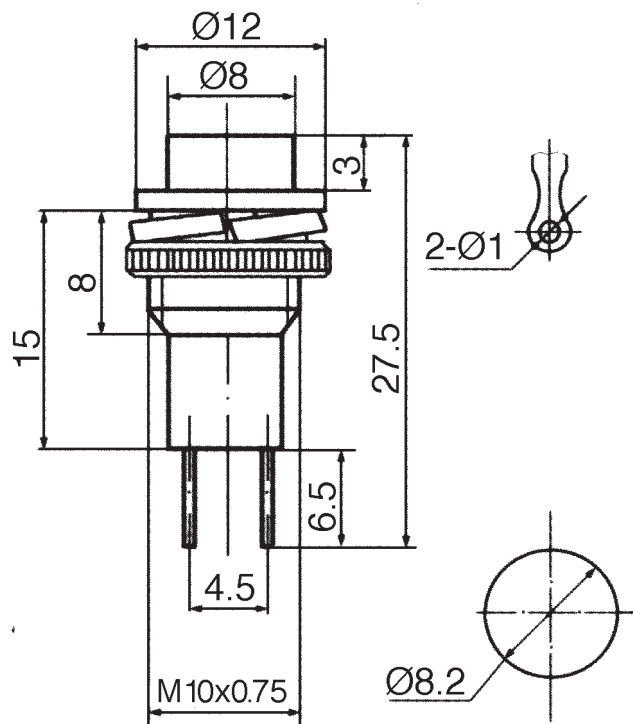

PUSH BUTTON SWITCH**OFF - (ON)****Dimensions****Specification**

Ambient temperature	Relative humidity	Operating voltage	Rated current
-55 ~ +85°C	98% +40°C	250VAC	0.5A
Contact resistance	Insulation resistance	Test Voltage	Actuating force
≤0.02Ω	≥100MΩ	1000V ~ 1	2 - 8N
Life			
10,000			

	TYPE	MODEL
4/6505 ÷ 4/6506	(Single blade) 2P	OFF - (ON)
		ON - (OFF)