

30/791

## EH-30B12 NI-MH (SIZE): BUTTON CELL

Cell Dimension (With shrink sleeve)

Diameter	$12 \pm 0.7$ mm
Height	$6.3 \pm 1.0$ mm
Approximate Weight	3 g

### Specifications

Nominal Voltage		1.2 V	
0.2C Discharge Capacity*		Typical **	35 mAh
		Nominal	30 mAh
Charge		Standard	3 mA for 14 to 16hr
		Fast	6 mA for 7 - 8 hr
Life Expectancy		500 cycles	
Operating Temperature	Charge	Standard	0°C to 40°C
		Fast	10°C to 30°C
	Discharge		-10°C to 40°C
	Storage	<6 months	0°C to 35°C
		<2 months	0°C to 45°C

\* After charging for 16 hr. with 0.1 C

\*\* Average capacity

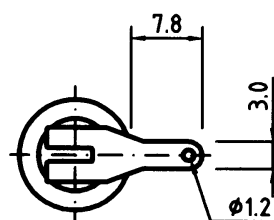
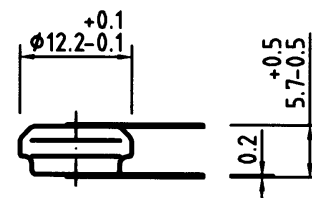

Charging curve of single cell EH-30B12 at 0.1C charging rate

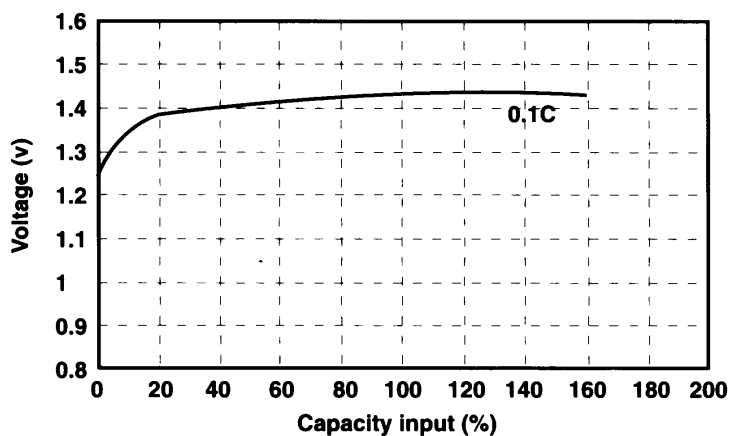

Discharge curves of single cell EH-30B12 at various discharge rates at room temperature.

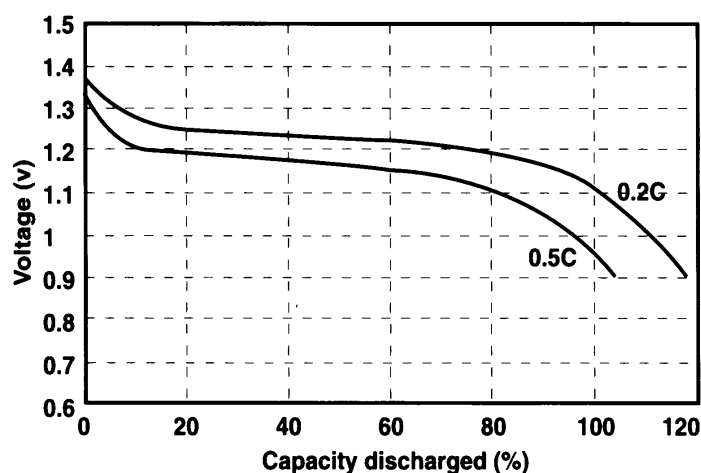

30/792

## EH-30B12 NI-MH (SIZE): BUTTON CELL

Cell Dimension (With shrink sleeve)

Diameter	$12 \pm 0.7$ mm
Height	$11 \pm 1.0$ mm
Approximate Weight	5 g

### Specifications

Nominal Voltage		2.4 V	
0.2C Discharge Capacity*		Typical **	35 mAh
		Nominal	30 mAh
Charge		Standard	3 mA for 14 to 16hr
		Fast	6 mA for 7 - 8 hr
Life Expectancy		500 cycles	
Operating Temperature	Charge	Standard	0°C to 40°C
		Fast	10°C to 30°C
	Discharge		-10°C to 40°C
	Storage	<6 months	0°C to 35°C
		<2 months	0°C to 45°C

\* After charging for 16 hr. with 0.1 C

\*\* Average capacity

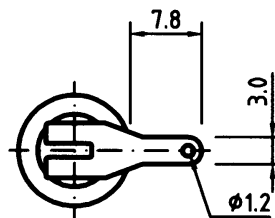
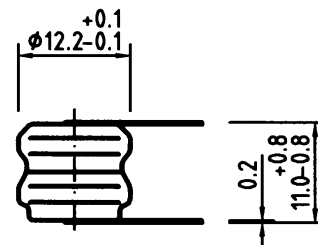

Charging curve of single cell EH-30B12 at 0.1C charging rate

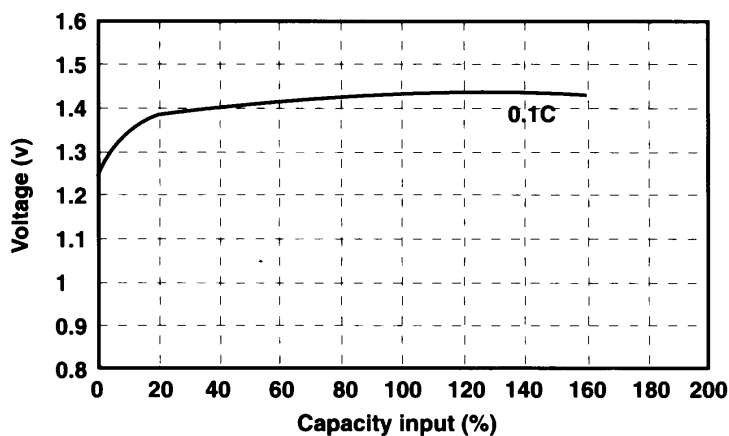

Discharge curves of single cell EH-30B12 at various discharge rates at room temperature.

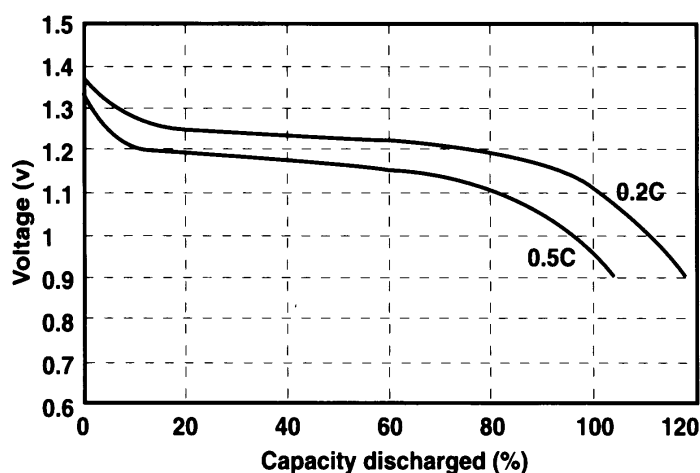

30/793

## EH-30B12 NI-MH (SIZE): BUTTON CELL

Cell Dimension (With shrink sleeve)

Diameter	$12 \pm 0.7$ mm
Height	$16.5 \pm 1.0$ mm
Approximate Weight	7 g

### Specifications

Nominal Voltage		3.6 V	
0.2C Discharge Capacity*		Typical **	35 mAh
		Nominal	30 mAh
Charge		Standard	3 mA for 14 to 16hr
		Fast	6 mA for 7 - 8 hr
Life Expectancy		500 cycles	
Operating Temperature	Charge	Standard	0°C to 40°C
		Fast	10°C to 30°C
	Discharge		-10°C to 40°C
	Storage	<6 months	0°C to 35°C
		<2 months	0°C to 45°C

\* After charging for 16 hr. with 0.1 C

\*\* Average capacity

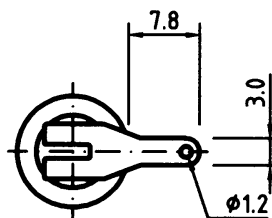
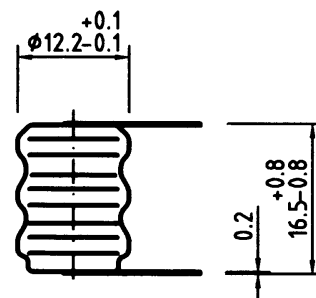

Charging curve of single cell EH-30B12 at 0.1C charging rate

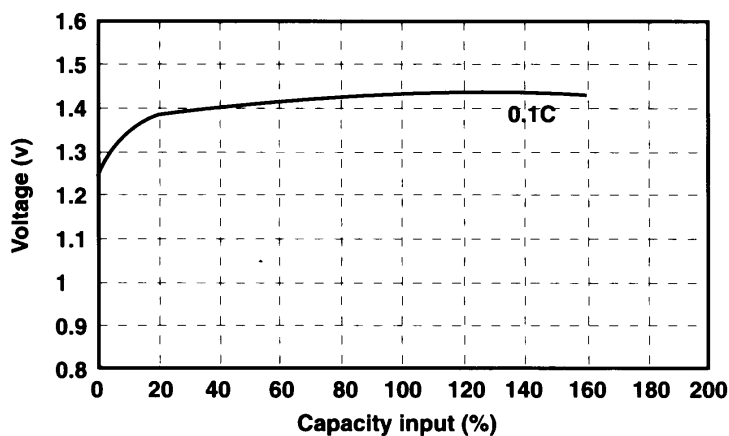

Discharge curves of single cell EH-30B12 at various discharge rates at room temperature.

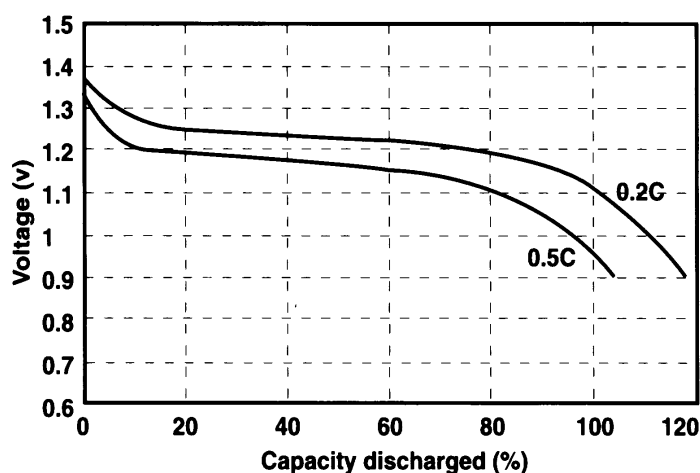

30/794

## EH-30B12 NI-MH (SIZE): BUTTON CELL

Cell Dimension (With shrink sleeve)

Diameter	$12 \pm 0.7$ mm
Height	$22 \pm 1.0$ mm
Approximate Weight	9 g

### Specifications

Nominal Voltage		4.8 V	
0.2C Discharge Capacity*		Typical **	35 mAh
		Nominal	30 mAh
Charge		Standard	3 mA for 14 to 16hr
		Fast	6 mA for 7 - 8 hr
Life Expectancy		500 cycles	
Operating Temperature	Charge	Standard	0°C to 40°C
		Fast	10°C to 30°C
	Discharge		-10°C to 40°C
	Storage	<6 months	0°C to 35°C
		<2 months	0°C to 45°C

\* After charging for 16 hr. with 0.1 C

\*\* Average capacity

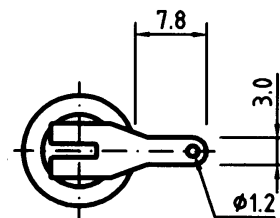
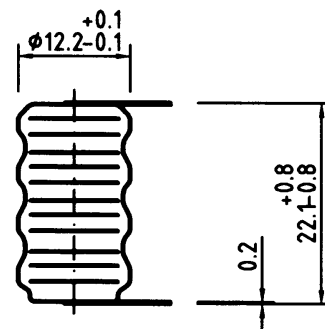

Charging curve of single cell EH-30B12 at 0.1C charging rate

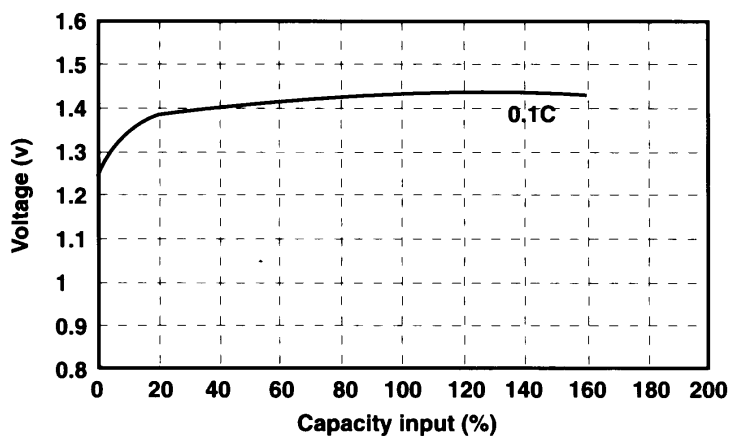

Discharge curves of single cell EH-30B12 at various discharge rates at room temperature.

