

VICTORY-e[®] VICD-30 Single Output Industrial DIN Rail Power Supply

Features:

Universal AC input/ full range
 Protections: Short circuit/ Over load/ Over voltage
 Cooling by free air convection
 Can be installed on DIN rail TS-3.5/7.5 or 15
 Isolation class α
 LED indicator for power on
 100% full load burn-in test
 Dimensions: 78*93*56mm (W*H*D)



MODEL		A RICHIESTA	13/19500	A RICHIESTA	13/19502
OUTPUT	DC VOLTAGE	5V	12V	15V	24V
	VOLTAGE TOLERANCE	± 2%	± 1%	± 1%	± 1%
	RATED CURRENT	3A	2A	2A	1.5A
	CURRENT RANGE	0-3A	0-2A	0-2A	0-1.5A
	RATED POWER	15W	24W	30W	36W
	RIPPLE & NOISE	80mVp-p	120mVp-p	120mVp-p	150mVp-p
	DC ADJUSTMENT RANGE	-5%,+10%	± 10%	± 10%	± 10%
	SETUP, RISE, HOLD TIME	100ms,30ms/230VAC 100ms,30ms/115VAC at full load			
INPUT	VOLTAGE RANGE	85÷ 264 VAC 47÷ 63 Hz; selected by switch 120÷ 370VDC			
	AC CURRENT	0.88 A/115 V 0.48A/ 230 V			
	EFFICIENCY	74%	81%	82%	83%
	INRUSH CURRENT	Cold start 15A/115V 30A/230V			
PROTECTION	OVER LOAD	105%÷ 160%			
		Protection type: Constant current limiting, recovers automatically after fault condition is removed			
	OVER VOLTAGE	115%÷135%			
		Protection type: Shut down o/p voltage, re-power on to recover			
ENVIRONMENT	WORKING TEMP., HUMIDTIY	-20°C÷ +60°C 20%÷ 90 %RH			
	STORAGE TEMP., HUMIDITY	-40°C÷ +85°C 10%÷ 95 %RH			
	VIBRATION	10÷ 500Hz, 2G 10min/1cycle, period for 60min, each along X, Y, Z axes			
SAFETY	WITHSTAND VOLTAGE	I/P-O/P: 3KVAC			
	ISOLATION RESISTANCE	I/P-O/P: 100M Ohms / 500VDC			
STANDARD	SAFETY STANDARD	Design refer to UL60950-1,TUV EN60950-1,EN50178			
	EMC STANDARD	Design refer to EN55011,EN55022,EN61000-3-2,-3,EN61000-4-2,3,4,5,6,8,11, ENV50204,EN55024,EN61000-6-2,EN61204-3			
OTHERS	WEIGHT	0.27Kg			
	PACKING	48pcs/14Kg/1.02CUFT			
NOTE	1. All parameters NOT specially mentioned are measured at 230VAC input, rated load and 25°C of ambient temperature. 2. Ripple & noise are measured at 20MHz of bandwidth by using a 12” twisted pair-wire terminated with a 0.1µ & 47µ parallel capacitor. 3. Tolerance: includes set up tolerance, line regulation and load regulation. 4. The power supply is considered a component which will be installed into a final equipment. The final equipment must be re-confirmed that it still meets EMC directives.				

30W Single Output Industrial DIN Rail Power Supply

VICD-30 Series

■ Outline and Dimension:

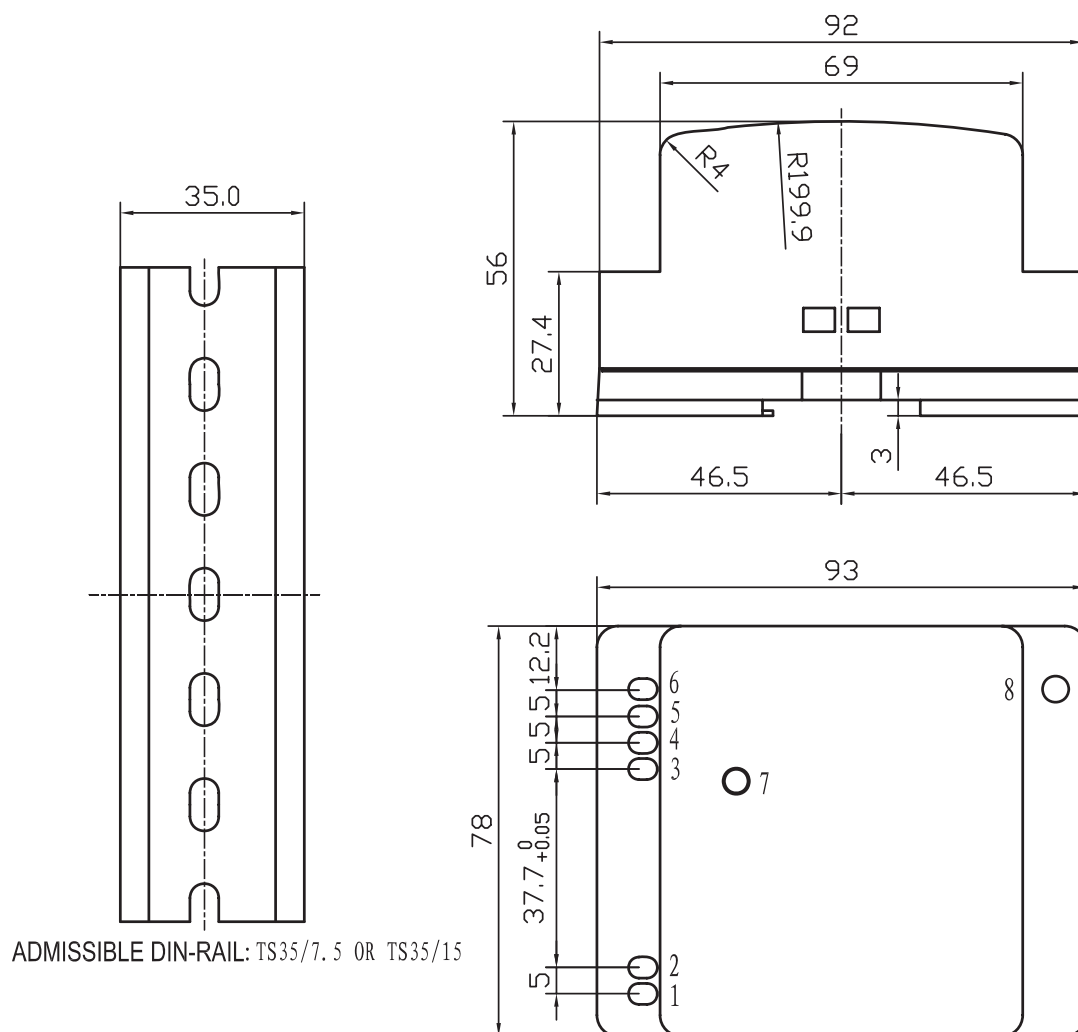

Terminal Pin No. Assignment:

Pin No.	Assignment	Pin No.	Assignment
1	AC/N	5, 6	-V
2	AC/L	7	LED
3, 4	+V	8	+V ADJ.

■ Output Derating

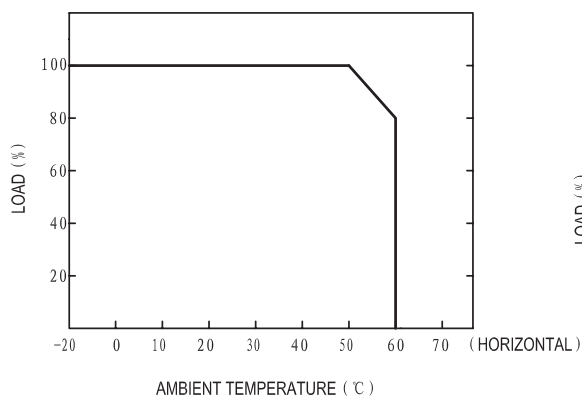

■ Output Derating VS Input Voltage

