

SMART CEILING LIGHT

ART.18/13015-00

PRODUCT SPECIFICATIONS

- Wi-Fi & Bluetooth Connection
- Voice Control
- No Hub Required
- Timer & Schedule
- Remote Control
- Grouping

| COLOR | INPUT VOLTAGE | Lumen Efficacy(lm/W) | Power(W) | PF | IP |
|-------|---------------|----------------------|----------|------|----|
| CCT | AC200-240V | 90 | 18 | >0.7 | 65 |

INSTALLATION

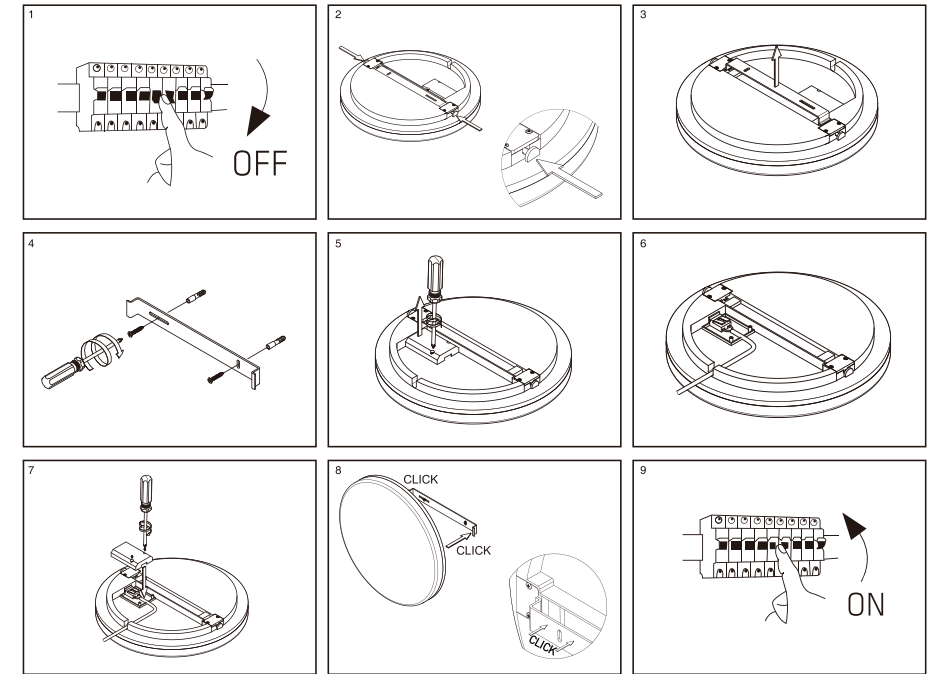

IMPORTANT INSTALLATION NOTICE

- When installing, make sure the distance between the flood light and any other objects is a minimum of 3 ft. to ensure effective heat dissipation.
- Though the smart flood light is waterproof for outdoor use and will function in the rain, it is not suitable to be used underwater.

ELCART DISTRIBUTION SPA via Michelangelo Buonarroti, 46 - 20093 Cologno Monzese (Milano) ITALY
Tel. +39 02 25117310 Fax +39 02 25117610 sito internet: www.elcart.com e-mail: tecnico@elcart.it

La divulgazione dei dati contenuti in questa scheda è da ritenersi un servizio puramente informativo e non costituisce alcun vincolo da parte della Elcart in merito a prestazioni ed utilizzo del prodotto. The divulgation of data contained on this technical sheet are exclusively for informational reasons and establish no link on behalf of Elcart regard to the performances and the use of the product. La divulgación de los datos contenidos en esta ficha son un servicio únicamente informativo y no constituyen ningún vínculo de parte de Elcart respecto a las prestaciones y uso del producto.

SMART FLOOD LIGHT SETUP

- Make sure to turn on Bluetooth on your mobile phone, and connect your mobile phone to WIFI Internet (2.4GHz).
- Download the Smart Life app to your mobile phone and install the app. To download the Smart Life app, you may search the keyword "Smart Life" in the Apple Store or on Google Play, or scan the QR code below:



- Create an account on Smart Life and login. Make sure to remember your account and password for Alexa or Google Assistant app pairing later.

- Turn on the Smart Ceiling Light and enter the home of APP, Smart Ceiling Light will flashing when turn on the power supply. Stay at the home page and found the push notification, then click "Go to add". If the light doesn't blink, please repeatedly press "on-off-off-on-off-on" on the smart ceiling light to activate the blinking mode on the light, making sure to maintain an interval of 1-2 seconds between each on and off.

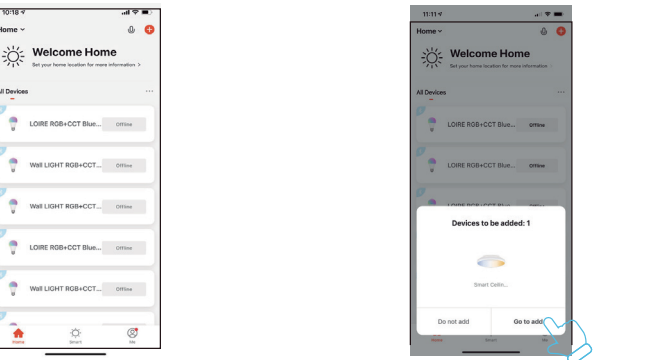

- Select the Wi-Fi connected to the smart device, input the Wi-Fi password, and then click "Next" to wait for the matching to succeed. (Make sure smart devices share the same Wi-Fi).

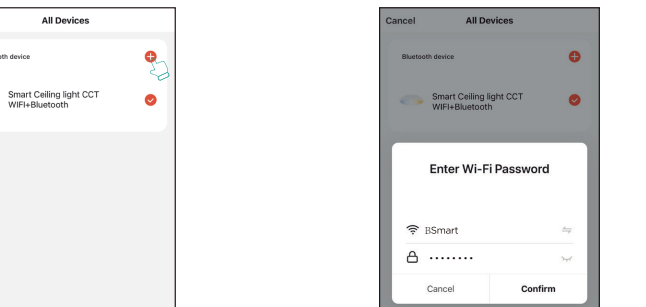

Add Device

Enter/Confirm Wi-Fi Password

- The interface of connecting will appear, when the device is found, the lamp will stop blinking and then initializing device will be complete. The Smart Ceiling Light is added once they are communicating on the same Wi-Fi Network. You can rename the smart device by clicking on the pencil icon. Press the "Done" button at the bottom of screen to continue to next step.

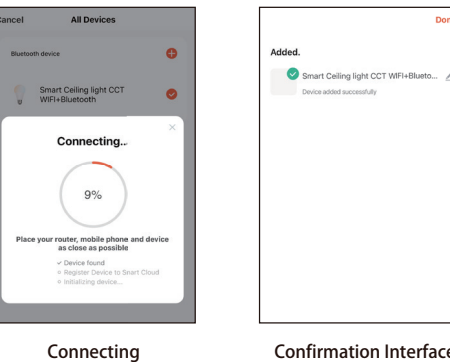

- The Smart Ceiling light will be shown on the homepage of the Smart Life app with light on. Turn off the power and wait at least 3s, then turn on the power again with APP. Press and hold at least 5 seconds on pairing button: The pairing process starts. The receiving lighting flash once after successful pairing. Now you can control the smart ceiling light with the smart life app or the remote control.

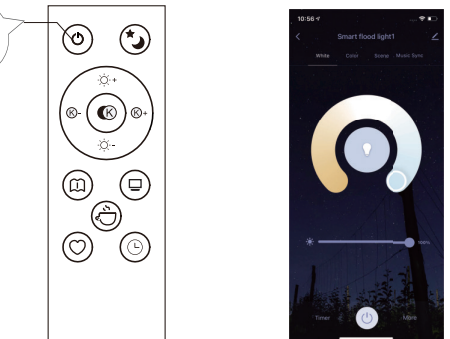

WARNING

- Please make sure that the light is connected to the APP and keep the BLE signal stable before connecting the remote control.
- The pairing should be complete within 30 seconds of turning the light off and then on.

After the remote control has been connected, the light can be controlled with the remote control even when there is no WiFi network.



CONTROL DEVICE

After the device is connected successfully. The device name of the smart lamp shows in the list. Tap it to enter the control panel of the Smart Ceiling light.

White Mode
Adjust brightness and
color temperature of white light.

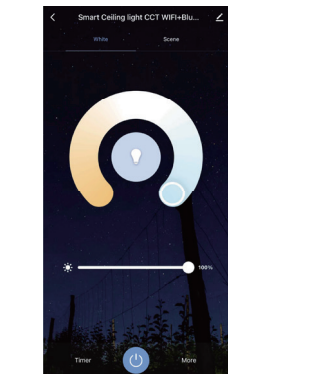

Scene Mode
Four scenes modes.

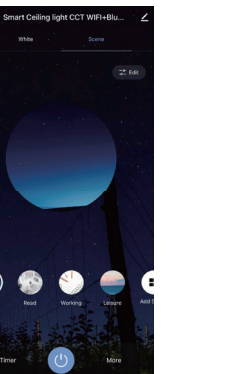

Timer
This will switch OFF the Smart Ceiling
Light in a specific duration of time.

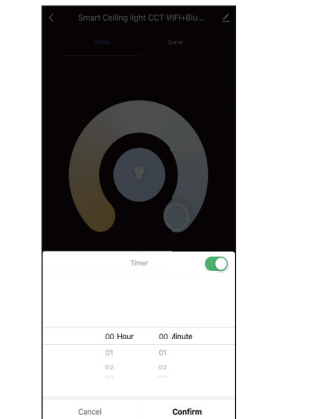

Schedule
This will keep the ceiling light in ON/OFF
position for a specific duration of time.

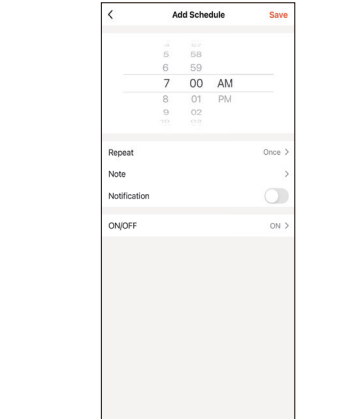

Sleep Plan

- Click "More".
- Click "Plan".
- You can select plan type "Sleep plan".
- First configure the hours (left).
- Next configure minutes (right).
- You can customize the repetition time.
- Click "Save" to save the settings.

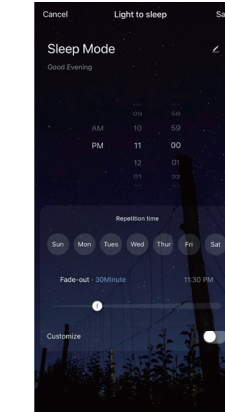

Wake Plan

- Click "More".
- Click "Plan".
- You can select plan type "Wake up plan".
- First configure the hours (left).
- Next configure minutes (right).
- You can customize the repetition time.
- Click "Save" to save the settings.

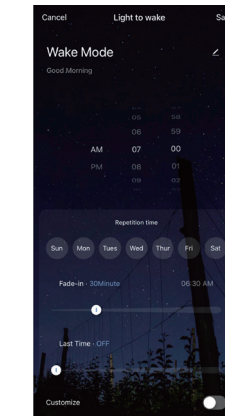

Circadian Rhythm

Change the color temperature of the lights adjusts naturally to keep your body in its natural rhythm. Light has a big effect on our circadian rhythm and our regular lighting interferes with your circadian rhythm causing health problems. Our Smart Ceiling Light can be programmed to give you the correct amount of light at the correct color temperature to work in harmony with our circadian rhythm instead of against it.

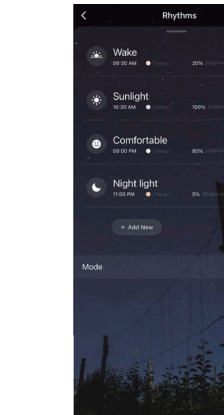
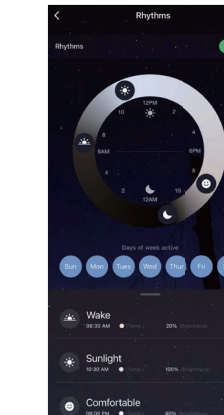

Grouping

If you got two or more light, please tap " " at the upper right corner of the control panel and create group. The smart lamp group will realize synchronous switch, color changes, the scene mode selection, timer, etc.

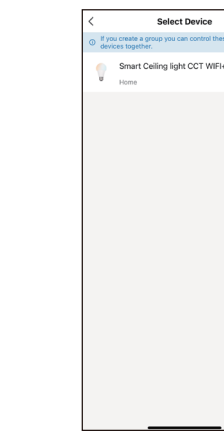
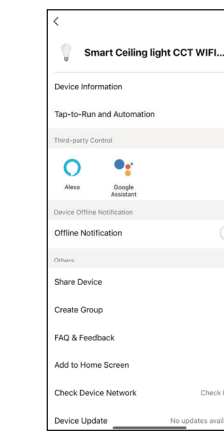

APP FUNCTION INTRODUCTION

Click the interface to control it according to the specific mode of the specific Smart Ceiling Light. The following is public function introduction.

- Remote control: The Smart Ceiling Light can be controlled anywhere after the smart device is successfully connected.
- Timer function: Set the timer to turn ON and turn OFF the Smart Ceiling Light.
- Intelligent scene: The system sets a variety of intelligent scenes, and different scenes correspond to different lighting atmospheres.
- Grouping: Group control is available (only for the same type of product). Family room management.
- Device Sharing: The device is shared with other user control devices in the home.

THIRD PARTY CONTROL

In the Tuya Smart APP: Find more service in "Me" menu, click to enter "voice service" (Alexa/ Google Assistant) and other services, click on the service you need. Connect to the third-party service device according to the operation guide.

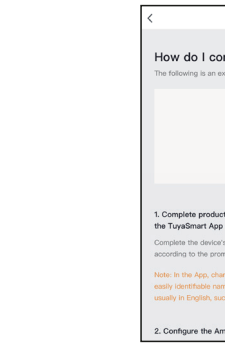
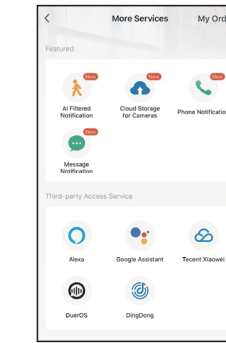

How to use the remote control

Before installation please read the Instructions and keep them for further reference. Should you have Questions feel free to contact us anytime.

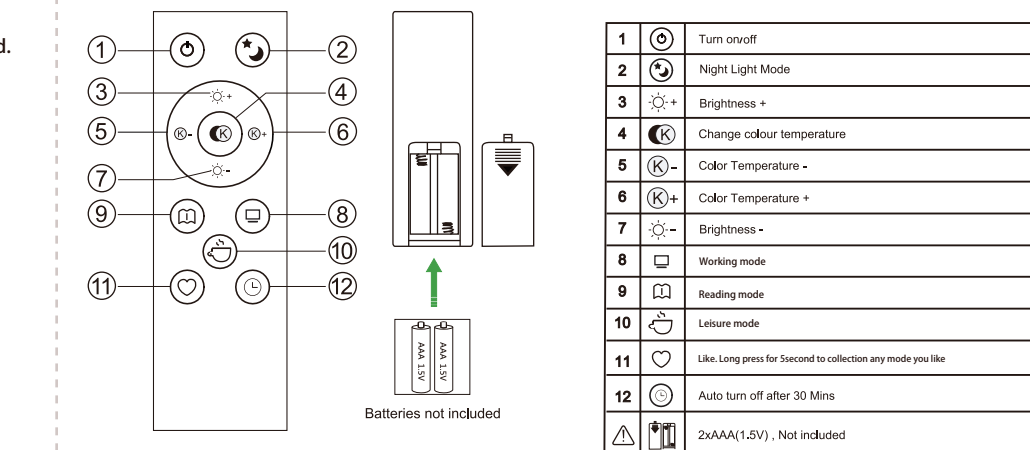

TECHNICAL DRAWING

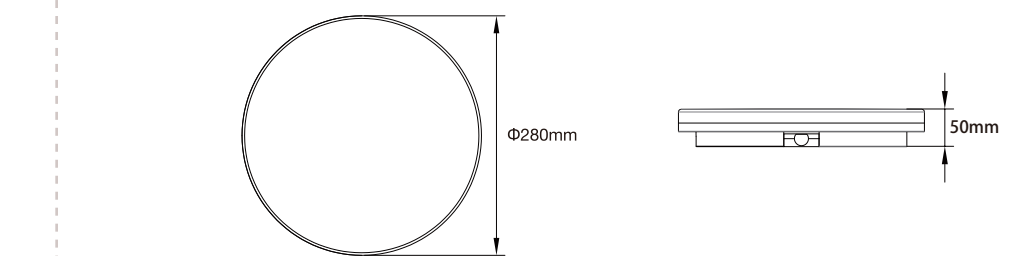

User information ex art. 26 D. 49/2014
The symbol labelled on the appliance (Annex IX D. 49/2014) indicates that the rubbish is subject to "separate collection" and it has been placed on the Italian market after the December 31, 2015. The user must therefore assign or (have collected) the rubbish to a treatment facility according to indications by the local administration, or hand it over to the reseller in exchange for an equivalent new product. The separate collection of the rubbish and the subsequent treatment, recycling and disposal operations encourage the production of appliances made with recycled materials and reduce negative effects on health and the environment caused by improper treatment of rubbish.
In the case of very small WEEE (no external dimension more than 25 cm), the user is eligible to get free of charge assignment to retail shops with sales areas relating to EEE of at least 400 m².

IMPORTED AND DISTRIBUTED BY:
ELCART DISTRIBUTION SPA
Via Michelangelo Buonarroti, 46
20093 COLOGNO MONZESE (MI)
ITALY
www.elcart.com - info@elcart.it



Made in China