



Specification for Magnetic Transducer	Page	2/10
Model No. : KPM-G1201A1-K6524	Revision No.	1.0
	Drawing No.	OEM6524R

## CONTENTS

1. Scope
2. General
3. Electrical and Acoustic Characteristics.
4. Reliability Test
5. Measurement Block Diagram & Response curve
6. Structure
7. Dimensions
8. Packing
9. Revision

Specification for Magnetic Transducer		Page	3/10
Model No. : KPM-G1201A1-K6524		Revision No.	1.0
		Drawing No.	OEM6524R

## 1. Scope

This product specification is applied to the Magnetic Transducer in alarm systems. Please contact us when using this product for any other applications than described in the above.

## 2. General

2.1 Out-Diameter : Ø12 mm

2.2 Height : 9.0 mm

2.3 Weight : 2 g

2.4 Operating Temperature range:  
-20°÷+70°C without loss of function

Store Temperature range:  
-30°÷+80°C without loss of function

2.5 According to the No.7 of RoHS Exemptions, lead-based solder alloys containing 85 % by weight or more lead(Sn10Pb90)

## 3. Electrical and Acoustic Characteristics.

Test condition : 15°÷35°C , 25% ÷ 85% RH, 860÷1060 mbar

	Items	Specification
1	Rated Voltage	1.5V
2	Operating Voltage	1÷2V
3	Max.Rated Current	30mA/1.5V
4	Resonant Frequency	2048Hz
5	Min.Sound Pressure Level	75dB/1.5V/2048Hz/10cm
6	Coil Resistance	16±2 Ω
7	Coil Impedance	40 Ω
8	Case Material/Color	PBT/BLACK

Specification for Magnetic Transducer		Page	4/10
Model No. : KPM-G1201A1-K6524		Revision No.	1.0
		Drawing No.	OEM6524R

## 4. Reliability Test

After test(1~7item), the transducer S.P.L . difference shall be within  $\pm 10\text{dB}$ , and the appearance not exist any change to be harmful to normal operation(e.g.cracks,rusts,damages and especially distortion).

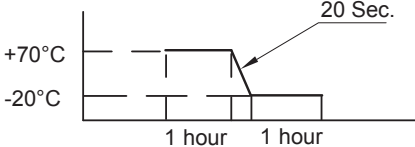
	Item	Specification
1	High Temperature Test	After being woked in a chamber with $+70^{\circ}\pm 2^{\circ}\text{C}$ for 2h and then being placed in natural condition for 2h, sounder shall be measured.
2	Low Temperature Test	First being worked in a chamber with $-20^{\circ}\pm 2^{\circ}\text{C}$ for 2h and then being placed in a chamber with $-20^{\circ}\pm 2^{\circ}\text{C}$ for 16h, finally being placed in natural condtion for 2h, sounder shall be measured.
3	Humidity Test	After being placed in a chamber with 90 to 95%R.H. at $+40^{\circ}\pm 2^{\circ}\text{C}$ for 2 h and then being placed in natural condition for 2h , sounder shall be measured.
4	Thermal Shock Test	<p>After being worked in a chamber at <math>+70^{\circ}\text{C}</math> for 1 hour, then sounder shall be placed in a chamber at <math>-20^{\circ}\text{C}</math> for 1 hour(1 cycle is the below diagram).</p> <p>After 6 above cycles, sounder shall be measured after being placed in natural condition for 1 hour.</p> 

Specification for Magnetic Transducer		Page	5/10
Model No. : KPM-G1201A1-K6524		Revision No.	1.0
		Drawing No.	OEM6524R

#### 4. Reliability Test

	Item	Specification
5	Vibration Resistance	Sounder shall be measured after being applied vibration of amplitude of 1.5mm with 10 to 30Hz band of vibration frequency to each of 3 perpendicular directions for 2 hour.
6	Drop Test	Sounder packed in the carton are dropped in six direction from the height of 80cm to the concrete floor.
7	Solderability	Lead terminals are immersed in rosin for 5 seconds and then immersed in solder bath of $+260 \pm 5^{\circ}\text{C}$ for $3 \pm 0.5$ seconds.
8	Terminal Strength Pulling	The force 10 seconds of 9.8N is applied go each terminal in axial direction.

Specification for Magnetic Transducer		Page	6/10
Model No. : KPM-G1201A1-K6524		Revision No.	1.0
		Drawing No.	OEM6524R

## 5. Measurement Block Diagram & Response curve

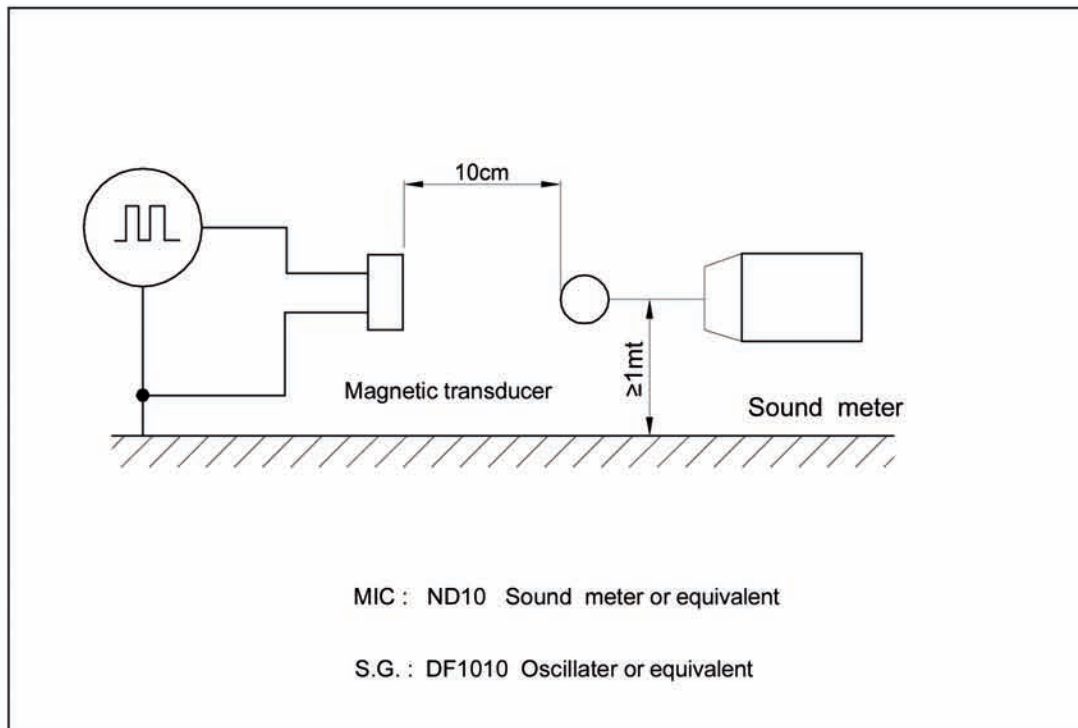

Specification for Magnetic Transducer		Page	7/10
Model No. : KPM-G1201A1-K6524		Revision No.	1.0
		Drawing No.	OEM6524R

## 6. Structure

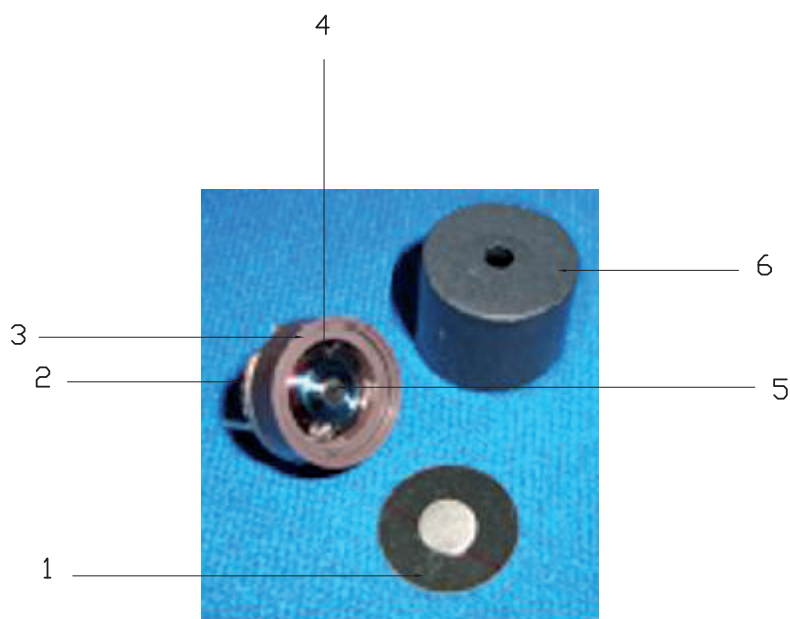

6	Case	1	PBT	
5	T Core	1	Fe	
4	Coil	1	QANR	
3	Magnetic ring	1	/	
2	PCB with pin	1	/	
1	Diaphragm	1	/	
No.	Part Name	Q'TY	Material	Remark

Specification for Magnetic Transducer		Page	8/10
Model No. : KPM-G1201A1-K6524		Revision No.	1.0
		Drawing No.	OEM6524R

## 7. Dimensions

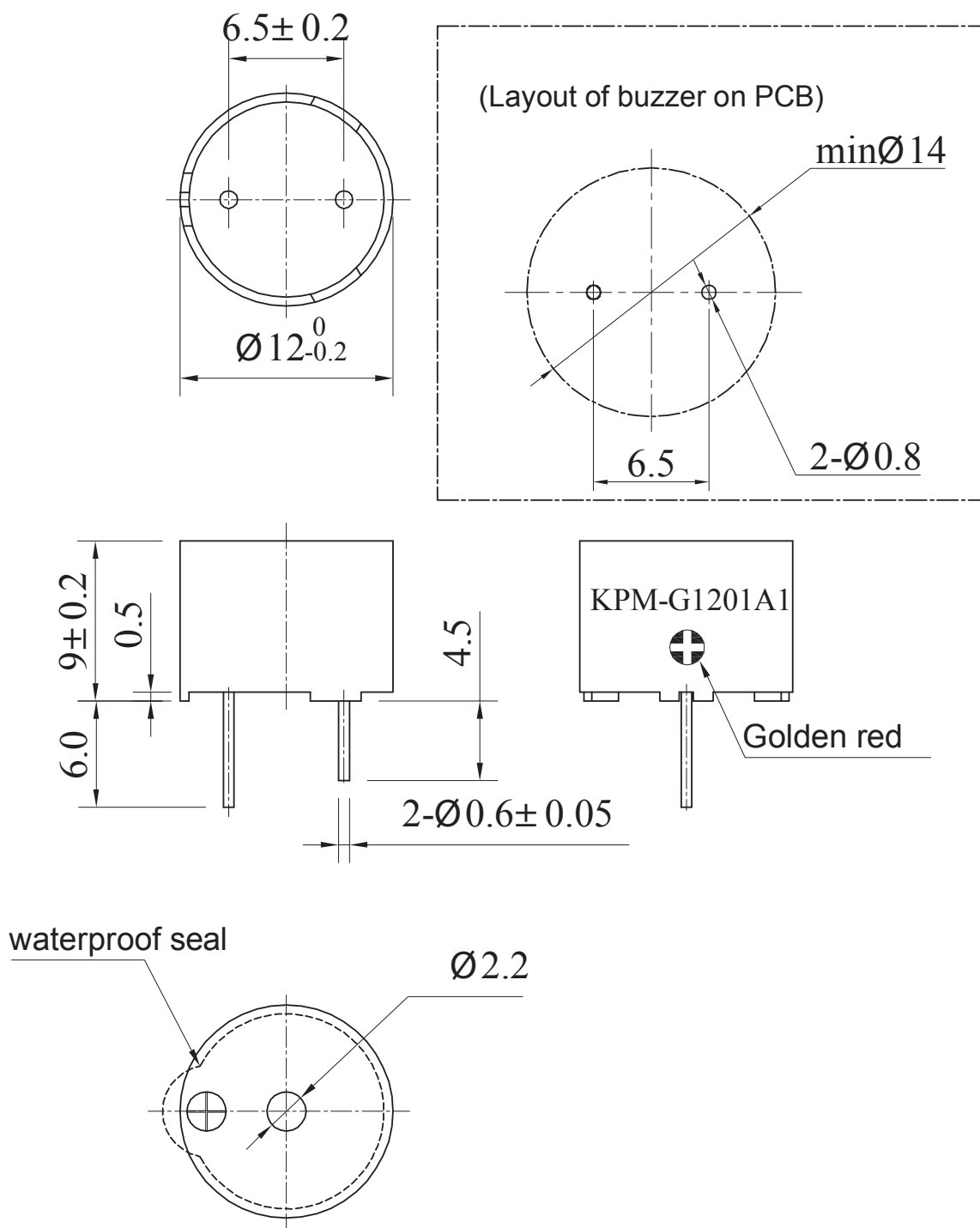

FIRST ANGLE PROJECTION



UNIT : mm

Tolerance :  $\pm 0.5$



Specification for Magnetic Transducer		Page	9/10
Model No. : KPM-G1201A1-K6524		Revision No.	1.0
		Drawing No.	OEM6524R

## 8. Packing



Picture1 100PCS



Picture2 500PCS



Picture3 500PCS



Picture4 6000PCS

QTY: 6000Pcs  
425 x400 x315